

Stainless Steel Balanced Pressure Thermostatic Steam Trap BT6

The BT6 thermostatic steam trap is designed for use in Clean Steam systems. All wetted parts are 316L stainless steel, with internal body surfaces finished to 32 microinches Ra. Condensate is discharged close to steam saturation temperature, which ensures minimal condensate back-up.

Model	BT6
PMO	88 psig
Sizes	Vertical 1/2", 3/4", 1" Horizontal connection 1/2" only.
Connections	Tri-Clamp® compatible sanitary clamp ends
Construction	316L Stainless Steel body & internals
Options	Buttweld & Screwed Connections are available on special request Fixed Bleed, Optional finishes Option mixed end connections

Typical Applications

Fermenter sterilization, steam barriers (block & bleed systems), sterilizer drainage and air venting, CIP/SIP system condensate drainage, and sterilization of process vessels and pipes.

* A registered trademark of Tri-Clover Inc.

Limiting Operating Conditions

Max. Operating Pressure (PMO) 88 psig (6 barg)

Max. Operating Temperature Saturated Steam Temperature

Pressure Shell Design Conditions

PMA 145 psig/0-338°F 10 barg/0-150°C
 Max. allowable pressure 132 psig/350°F 9 barg/177°C

TMA 350°F/0-132 psig 177°C/0-9 barg
 Max. allowable temperature

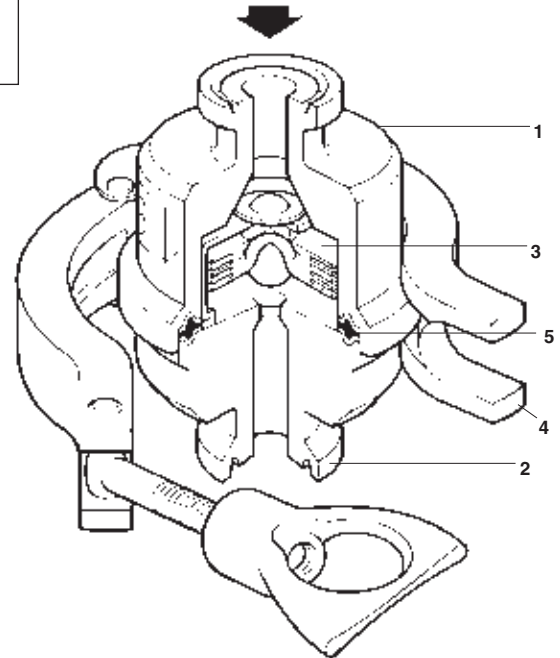

Capacities

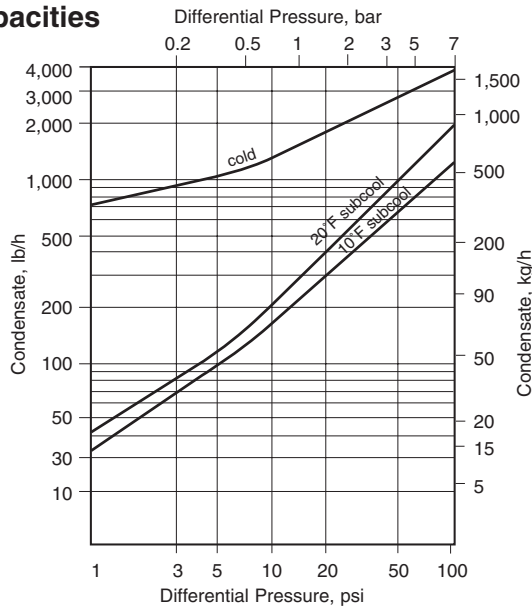

Construction Materials

No.	Part	Material
1	Body (Inlet Side)	Stainless Steel ASTM A276-87 Gr. 316L
2	Body (Outlet Side)	Stainless Steel ASTM A276-87 Gr. 316L
3	Element	Stainless Steel AISI 316L
4	Body Clamp	Stainless Steel AISI 304
5	Gasket	PTFE Jacketed Viton

Note: PTFE complies with FDA, CFR title 21, paragraph 177, section 1550. All wetted parts of this trap are constructed from FDA approved materials.

Material Certification

Actual mill test reports covering the BT6 body material are available if specified at the time of ordering.

Local regulation may restrict the use of this product below the conditions quoted. Limiting conditions refer to standard connections only.
 In the interests of development and improvement of the product, we reserve the right to change the specification.

Stainless Steel Balanced Pressure Thermostatic Steam Trap BT6

Dimensions standard BT6 (nominal) in inches and millimeters					
Size	A	B	C	D	E
1/2", 3/4", 1"	2.6	2.1	2.1	1.4	3.3
	65	54	5.3	35	84
Weight	1/2"		3/4"		1"
lb	1.9"		1.9		2.2
kg	0.85		0.85		1.0

Standard BT6

Clamp omitted in this view

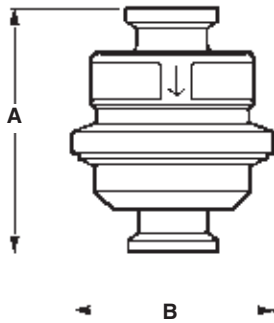

BT6 Horizontal

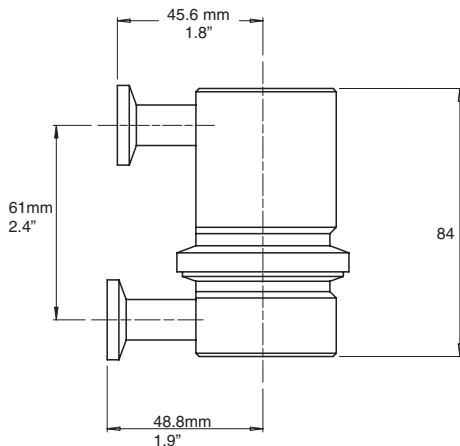
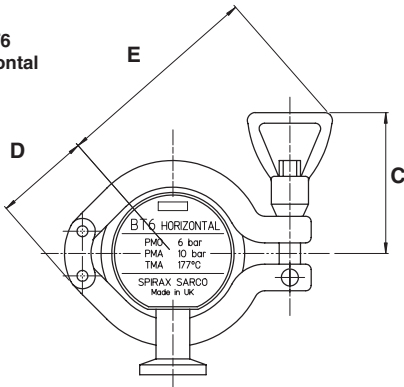

Spare Parts

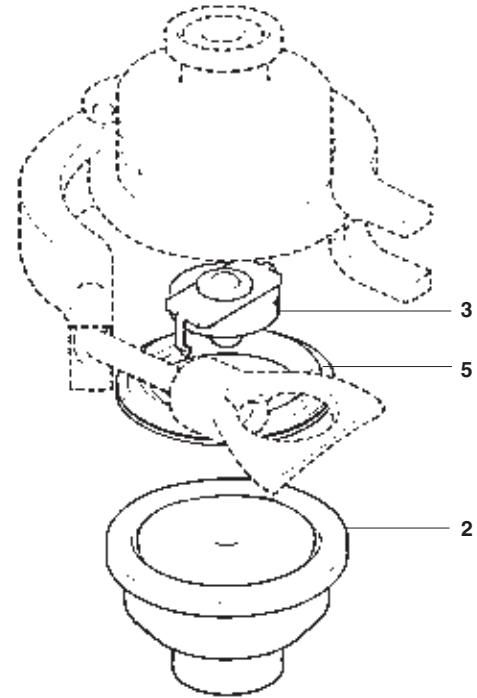

Element Assembly	3
End Connection (Outlet Orifice)	
Specify end type	2
Gasket (Pkt of 3)	5

Trap shown with Tri-Clamp connections. For other connection details, please consult factory.

Installation

The trap is designed to be fitted in vertical lines with the flow downwards so that it can be completely self-draining. Check flow arrow for correct orientation. Fittings, clamps and gaskets for pipe end connections are not supplied. Do not over expose the element to superheat conditions since over expansion may result.

Note: The body and element must be handled carefully to ensure that the machined surfaces are not damaged.

Sample Specification

Steam trap shall be self-adjusting balanced pressure type capable of operating close to saturated steam temperature. All wetted parts shall be manufactured from 316L grade stainless steel with body parts finished internally and externally to 32 micro inches Ra. Trap shall have body clamp to allow maintenance of internals, and shall be completely self-draining when installed in vertical pipeline.

Maintenance

Before undertaking any maintenance on the trap, it must be isolated from the supply line and return line and any pressure allowed to normalize to atmosphere. The trap assembly should then be allowed to cool.

TI-2-000-US 01.08